

Espire Elbow Spare Battery and Charging Parts

Part Number	Description
1 EE-BAT	Espire Elbow Batteries
1a EE-CH-1UK	Espire Battery Charger - Single Bay (UK)
EE-CH-1EU	Espire Battery Charger - Single Bay (Europe)
EE-CH-1US	Espire Battery Charger - Single Bay (US)
1b EE-CH-2UK	Espire Battery Charger - Dual Bay (UK)
EE-CH-2EU	Espire Battery Charger - Dual Bay (Europe)
EE-CH-2US	Espire Battery Charger - Dual Bay (US)
1c EE-CCH-UK	Espire Battery Car Charger (UK)
EE-CCH-EU	Espire Battery Car Charger (Europe)
EE-CCH-US	Espire Battery Car Charger (US)



Espire Elbow Additional Battery Doors

Part Number	Espire Pro/Hybrid
EEH-BDJ	Battery Door - Jet Black
EEH-BDC	Battery Door - Caucasian
EEH-BDB	Battery Door - Brown
EEH-BDS	Battery Door - Silver
EEH-BDW	Battery Door - White
EEH-BD001	Battery Door - Carbon Fibre

Part Number	Espire Classic Plus
EECP-BDJ	Battery Door - Jet Black
EECP-BDC	Battery Door - Caucasian
EECP-BDB	Battery Door - Brown
EECP-BDS	Battery Door - Silver
EECP-BDW	Battery Door - White
EECP-BD001	Battery Door - Carbon Fibre

Elbow Units and External Joints - Espire™ Elbow Additional Parts



A/C Myoelectrodes with TruSignal™ Technology

Myoelectric input for the Espire Pro and Hybrid models, that can be adjusted using the Espire Hub App. These electrodes utilise TruSignal technology which buffers a signal immediately, sending it to the microprocessor and then amplifying it. The benefit of amplifying the signal later in the process is that it results in a clean and clear signal. The result is better slow speed control of the elbow and its accessories.

The TruSignal electrode kit includes a wire harness with snap-electrode connection, and a set of metal domes. Espire Elbow and TruSignal Electrode Fabrication Instructions can be found at www.steepergroup.com.

TruSignal Electrodes Ordering Information

Part ID		No. of Sites	Cable Length	Dome Size
CP	-	TLE	-	-

Example Part Number:	
TruSignal AC Electrode Kit, 2 site, 12" cable length with medium dome size:	CP-TLE-212-M

No. of Sites	Cable Length	Dome Size
1 Site	6" 06	Large L
2 Site	12" 12	Medium M
3 Site	24" 24	Paediatric P
4 Site		

Part Number	Description
EE-CB-TL	TruSignal Circuit Board (Installed)
EE-CBK-TL	TruSignal Circuit Board Kit

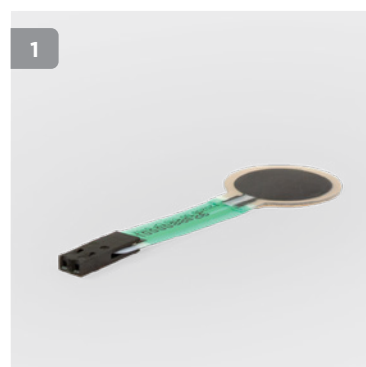

Touch Pads

The Steeper Touch Pads provide control and switching options for the Espire Elbow. Designed to be mounted into a socket, the control set up and adjustments to patient preferences can be configured using the Espire Hub App for iPad - see the Espire Hub App Technical Instructions for more details.

For use with the Espire Pro and Hybrid.

Part Number	Description
1 CP-TP-01	Single Touch Pad
1a CP-TPK-01	Touch Pad with Cable
1b CP-TPC	Touch Pad Cable



Linear Transducers

The Linear Transducer provides proportional servo control to a prosthetic elbow. It consists of a linear potentiometer in a small housing with an attached 200mm (8") Bowden sheath. A Spectra cord (approx 584mm/23") exits the sheath and is supplied with a 1" plastic hanger for attaching to the harness. Pulling the cord changes the resistance of the potentiometer, thus changing the speed and position of the device.

For more information on mounting the Transducer, please refer to the Technical Manual which can be found on www.steepergroup.com.

Part Number	Description
CP-LT-01	Linear Transducer



Espire Bump Switch

Part Number	Description
EE-BS	Espire Bump Switch



Forearm Cable Lift Kit

Lift-assist option for cable-controlled prostheses. Kits include a leather cable loop, 2-pc rivet, 10-32 fasteners (2), bushings (2), and a 1/4" drill bit with collar. To be used on the Espire Hybrid, Classic Plus, Classic and Basic.

Part Number	Description	To Fit
EE-FCL-E	Forearm Cable Lift Kit, Extended	Standard size elbows (50mm) with medial dial placement
EE-FCL-S	Forearm Cable Lift Kit, Standard	All elbows except standard size (50mm) elbow with medial dial placement

Elbow Units and External Joints - Espire™ Elbow Additional Parts

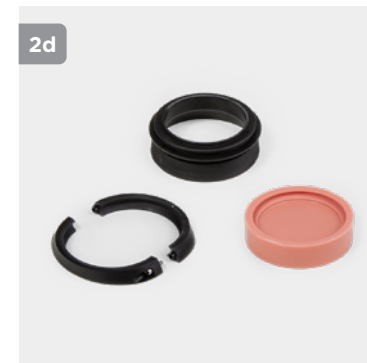
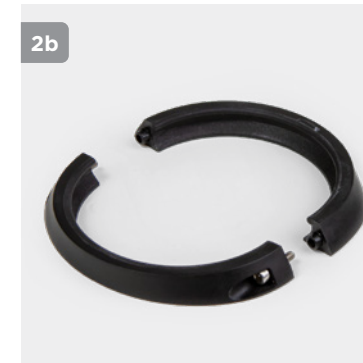
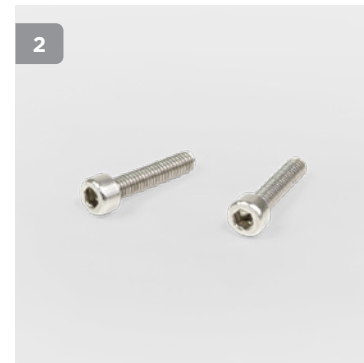

Espire Elbow Lamination Parts

Part Number	Description
2	EE-CS Elspire Elbow Lamination Clamp Screws (2pc) M2.5 x 12mm
2a	EE-LCO Elspire Elbow Lamination Collar
2b	EE-LCP Elspire Elbow Lamination Clamp
2c	EE-LD Elspire Elbow Lamination Dummy
2d	EE-LK Elspire Elbow Complete Lamination Kit



Espire Elbow Additional Parts

Part Number	Description
EE-CP-DC	Espire DC Cased Electrode Cable