

## Modular Arm System Components



A truly modular system with multiple interchange options, allows for rapid assembly and provides a light and easily adjustable alternative for transradial through to shoulder disarticulation levels. Finished in soft foam, our modular arm system gives a “soft feel” when compared to exoskeletal systems and may be shaped for added cosmetic result.

Growth may also be easily accommodated through the use of system components. For transhumeral and higher levels, the upper and lower forearm are connected through an elbow joint that may be manually locked in any one of four positions. The elbow joint is also suited to long transhumeral residual limbs due to its reduced build height option.

An overview prescription guide for Modular Arm System Components is available on pages 13-14.

## Modular Arm System Components

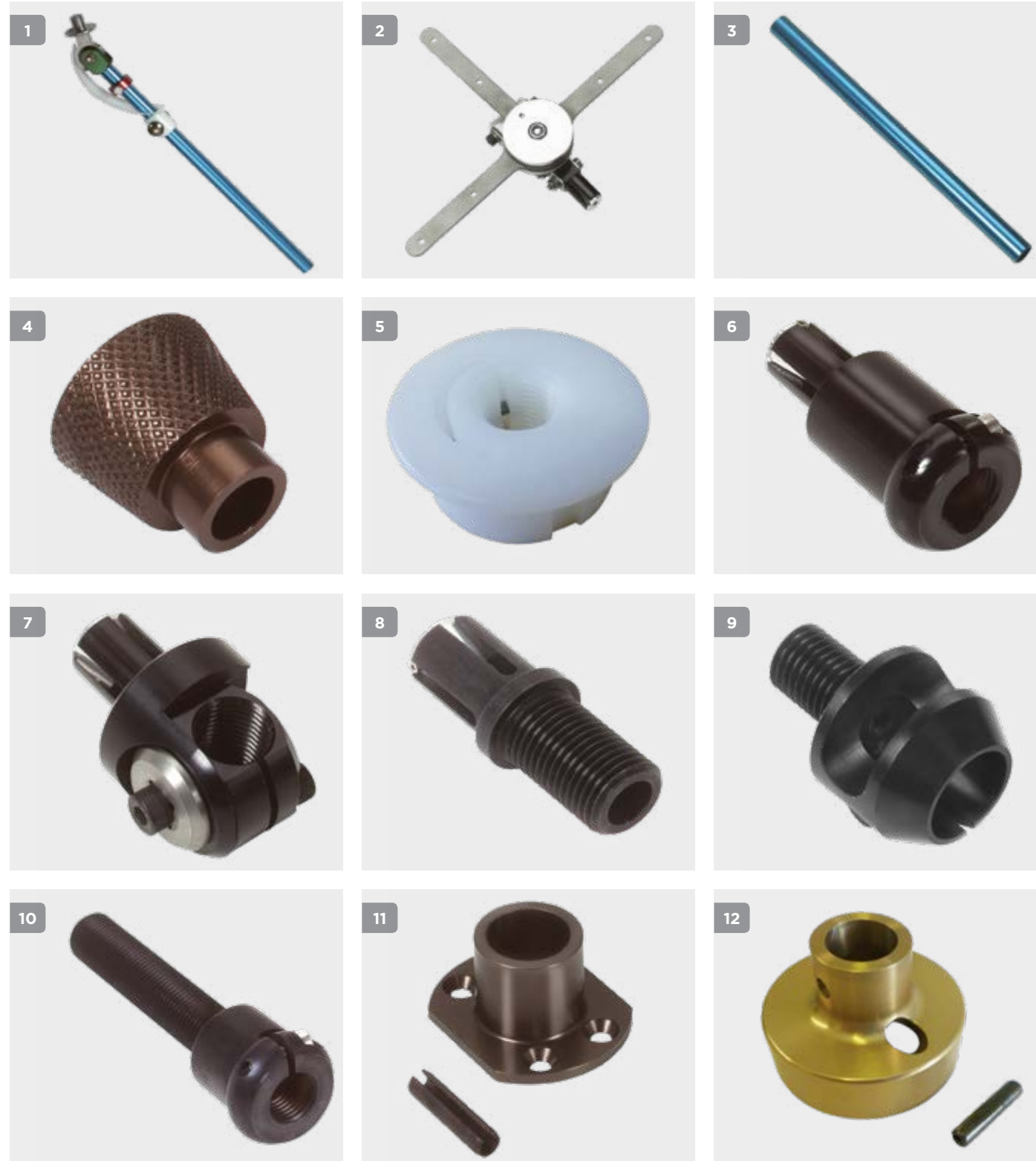

### Elbow Unit

Part Number	Description	Weight
-------------	-------------	--------

1	C22750 Elbow Unit - hand operated, four lock positions. Tubular construction in aluminium	230g (8 oz)
---	---	-------------

Minimum Proximal Build Height using Friction Housing - 45mm

Minimum Forearm Length using Friction Wrist or Oval Adapter - 135mm

Minimum Forearm Length using Female Adapters - 140mm Proximal Thread ½" UNF X 20 TPI

### Shoulder Unit

Part Number	Description	Weight
-------------	-------------	--------

2	C22751 Arm Shoulder Unit - two independent friction controls for flexion / extension and abduction / adduction	170g (6 oz)
---	--	-------------

Limit stop on flexion / extension range

### Connection Tube

Part Number	Description	Weight
-------------	-------------	--------

3	B22753 Aluminium Connection Tube, 230mm (9") Long	46g (1 ½ oz)
---	---	--------------

15.6mm (5/8") Outer Diameter 12.7mm (½") Inner Diameter

### Socket Interface

Part Number	Description	Weight	Height
-------------	-------------	--------	--------

4	B06576 Lamination Adapter, Fixed. Supplied with Split Pin (NPN0009)	30g (1 oz)	39mm (1 ½")
---	---	------------	-------------

Direct attachment to Connection Tube B22753

### Friction Housing

Part Number	Description	Thread	Weight	Height
-------------	-------------	--------	--------	--------

5	NHD55108 Friction Housing 40mm (1 ½")	Internal Thread ½" UNF x 20 TPI	23g (1 oz)	16mm (5/8")
---	---------------------------------------	---------------------------------	------------	-------------

	NHD55109 Friction Housing 45mm (1 ¾")	Internal Thread ½" UNF x 20 TPI	28g (1 oz)	16mm (5/8")
--	---------------------------------------	---------------------------------	------------	-------------

	NHD55110 Friction Housing 50mm (2")	Internal Thread ½" UNF x 20 TPI	35g (1 oz)	16mm (5/8")
--	-------------------------------------	---------------------------------	------------	-------------

Adjustable collar applies constant friction to thread

### System Adapters

Part Number	Description	Thread	Weight	Height
-------------	-------------	--------	--------	--------

6	B22513 Female Tube Adapter - To be used as wrist option on C22750, or link proximal C22750 with Connector Tube B22753	Internal Thread ½" UNF x 20 TPI	33g (1 oz)	50mm (2")
---	---	---------------------------------	------------	-----------

	B23370 Female Tube Adapter - To be used as wrist option on C22750	Internal M12 Thread	33g (1 oz)	50mm (2")
--	---	---------------------	------------	-----------

7	B22760 Universal Wrist Adapter - To be used as wrist option on C22750. Allows constant friction control over wrist flexion / extension and rotation	Internal Thread ½" UNF x 20 TPI	34g (1 oz)	27.5mm (1 1/8")
---	---	---------------------------------	------------	-----------------

8	B22518 Male Tube Adapter - Allows connection between Connection Tube B22753 and Friction Housing NHD55108 - NHD55110	Internal Thread ½" UNF x 20 TPI	12g (½ oz)	41mm (1 5/8")
---	--	---------------------------------	------------	---------------

9	B22766 Female Tube Adapter - To be used as wrist option on C22750, links to hands with female M12 thread	External M12 x 1.5mm	20g (½ oz)	22mm (7/8")
---	--	----------------------	------------	-------------

10	B22762 Extension Female Adapter - Allows an existing system to be lengthened	½" UNF x 20 TPI External to Internal thread	37g (1 oz)	27mm (1 1/8")
----	--	---	------------	---------------

11	B06856 Hand Connection Plate - Oval no rotation. Supplied with NPN0009 For use with passive hands with oval wrist option.		15g (½ oz)	20mm (¾")
----	---	--	------------	-----------

12	B17950 Friction Wrist Adapter 50mm (2") - Supplied with NPN0009 For use with 2" Friction Wrist and Connection Plates. Please see page 117-118		44g (1 ½ oz)	32mm (1 ¼")
----	---	--	--------------	-------------

	B17951 Friction Wrist Adapter 54mm (2 1/8") - Supplied with NPN0009 For use with 2 1/8" Friction Wrist and Connection Plates. Please see page 117-118		50g (2 oz)	32mm (1 ¼")
--	---	--	------------	-------------

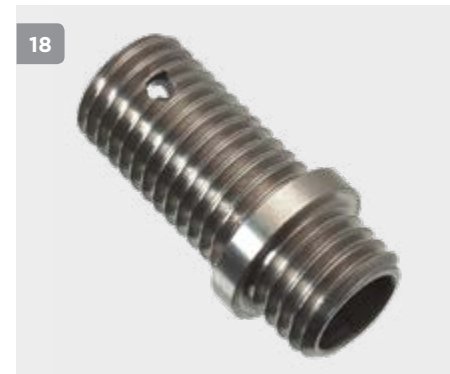

## Friction Housing

Part Number	Description	Thread	Weight	Height
13 B22505	Multi-Axial Wrist Housing 54mm (2 1/8") - Attaches to 54mm Hand Connection Plate. Ball Insert supplied separately		48g (1 1/2 oz)	25mm (1")
14 B22763	Free Flexion Ball Insert - Allows rotation, flexion and extension	Internal Thread 1/2" UNF x 20 TPI	19g (1/2 oz)	24mm (1")
B22503	Free Flexion Ball Insert - Allows rotation, flexion and extension	Internal Thread 3/8" BSW	20g (1/2 oz)	24mm (1")
15 B22764	Locked Flexion Ball Insert - Allows rotation only	Internal Thread 1/2" UNF x 20 TPI	21g (1/2 oz)	26.5mm (1")
B22765	Locked Flexion Ball Insert - Allows rotation only	Internal Thread 3/8" BSW	23g (1/2 oz)	26.5mm (1")

## Hand Plates - (North American) For use with Modular Arm System Adapters

Part Number	Wrist Size	External Thread	Shape	Weight	Height
16 B22758	40mm (1 1/2")	1/2" x 20 TPI	Round - Ottobock Hand Attachment	16g (1/2 oz)	25mm (1")
B22757	45mm (1 3/4")	1/2" x 20 TPI	Round - Steeper Hand Attachment	16g (1/2 oz)	25mm (1")
B22756	50mm (2")	1/2" x 20 TPI	Round - Steeper Hand Attachment	17g (1/2 oz)	25mm (1")
B22755	54mm (2 1/8")	1/2" x 20 TPI	Round - Steeper Hand Attachment	19g (1/2 oz)	25mm (1")

B22758, B22757, B22756 and B22755 are also compatible with Ottobock fastening arrangements

17 B06257	45mm (1 3/4") Oval	1/2" x 20 TPI	Oval Wrist Passive Hand	10g (1/2 oz)	25mm (1")
-----------	--------------------	---------------	-------------------------	--------------	-----------

## Threaded Insert

Part Number	Description
18 B26431	Threaded Stem. M12 x 1.5mm - 1/2" x 20 TPI
B26430	Threaded Stem. M12 x 1.5mm - M12 x 1.5mm

## Inner Foam Cosmesis

Part Number	Description	Weight
19 C11151	Inner Foam Cosmesis - Transhumeral	134g (5 oz)
C11152	Inner Foam Cosmesis - Transradial	134g (5 oz)

## Outer Fabric Cosmesis

Part Number	Description	Thread	Length
20 NOB0002	Stockinette Cover	Flesh Pink	1m lengths

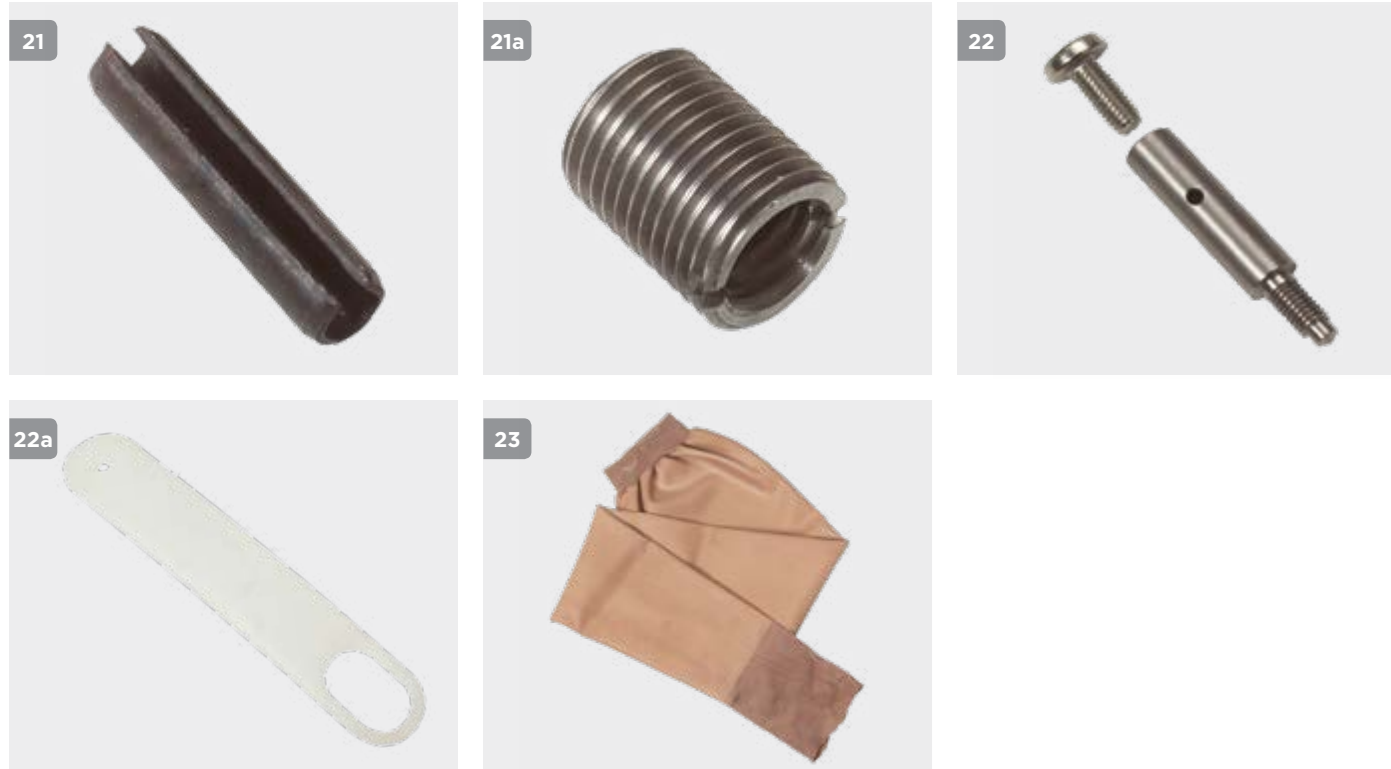

Other Spare Parts - Elbow Unit

Part Number	Description	Supplied
21	NPN0009 Split Pin	Each
21a	B06005 Conversion Sleeve - External Thread ½" UNF x 20 TPI, Internal Thread ⅜" BSW To convert UK External Thread to US External Thread	Each
	B23372 Conversion Sleeve - External Thread ½" UNF x 20 TPI, Internal Thread ⅜" BSF To convert UK Child External Thread to US External Thread	Each

Other Spare Parts - Elbow Unit

Part Number	Description
22	B22843 Flexion Bar links to C22750 with red bar (Metric)
	NSC0027 Screw for Flexion Bar - M5 x 12mm (Metric)
22a	B05036 Elbow Guard

Outer Silicone Cosmesis

Part Number	Description	Colour	Size
23	NGL0010 Silicone Cover	Flesh Pink	Small
	NGL0011 Silicone Cover	Suntan	Small
	NGL0012 Silicone Cover	Mid Brown	Small
	NGL0013 Silicone Cover	Dark Brown	Small
	NGL0014 Silicone Cover	Flesh Pink	Medium
	NGL0015 Silicone Cover	Suntan	Medium
	NGL0016 Silicone Cover	Mid Brown	Medium
	NGL0017 Silicone Cover	Dark Brown	Medium
	NGL0018 Silicone Cover	Flesh Pink	Large
	NGL0019 Silicone Cover	Suntan	Large
	NGL0020 Silicone Cover	Mid Brown	Large
	NGL0021 Silicone Cover	Dark Brown	Large

Colours for Outer Silicone Cosmesis (for indication only).

