

TECHNICAL INSTRUCTIONS



The Accent provides 2" of heel height adjustment through the simple push of a button. With superior cosmetic finishing options in a service-free foot design, it accommodates the most demanding footwear preferences.



PACKAGE CONTENTS (IP)	PACKAGE CONTENTS (DP)
(1) Accent Foot, with Bonded Foot Shell	(1) Accent Foot, with Bonded Foot Shell
(1) Ankle Fairing	(1) Ankle Fairing
(1) CA Adhesive	(1) Sleeve Adapter
	(1) Pylon Adapter (4-hole, Male or Female)
	(1) DP Cutting Jig
	(1) CA Adhesive

Technical Assistance / Emergency Service 24-7-365

College Park's regular office hours are Monday thru Friday, 8:30 AM – 5:30 PM (EST). After hours, an emergency Technical Service number is available to contact a College Park representative.



MADE IN THE USA CE
185 INS AC TIS 140108

COLLEGE PARK INDUSTRIES
27955 College Park Dr. Warren, MI 48088 USA

EC REP EMERGO EUROPE
Molenstraat 15, 2513 BH, The Hague, Netherlands

©2014 College Park Industries, Inc. All rights reserved. College Park and Accent are registered trademarks of College Park Industries. FootHorn, CPI Sock and TruLube are trademarks of College Park Industries. US Patent No. 7,862,622.

FOOT COMPONENTS

The following diagram is to help familiarize you with the Accent's unique parts. They are referenced in the instructions, and used in assembling the foot or talking with technical service.

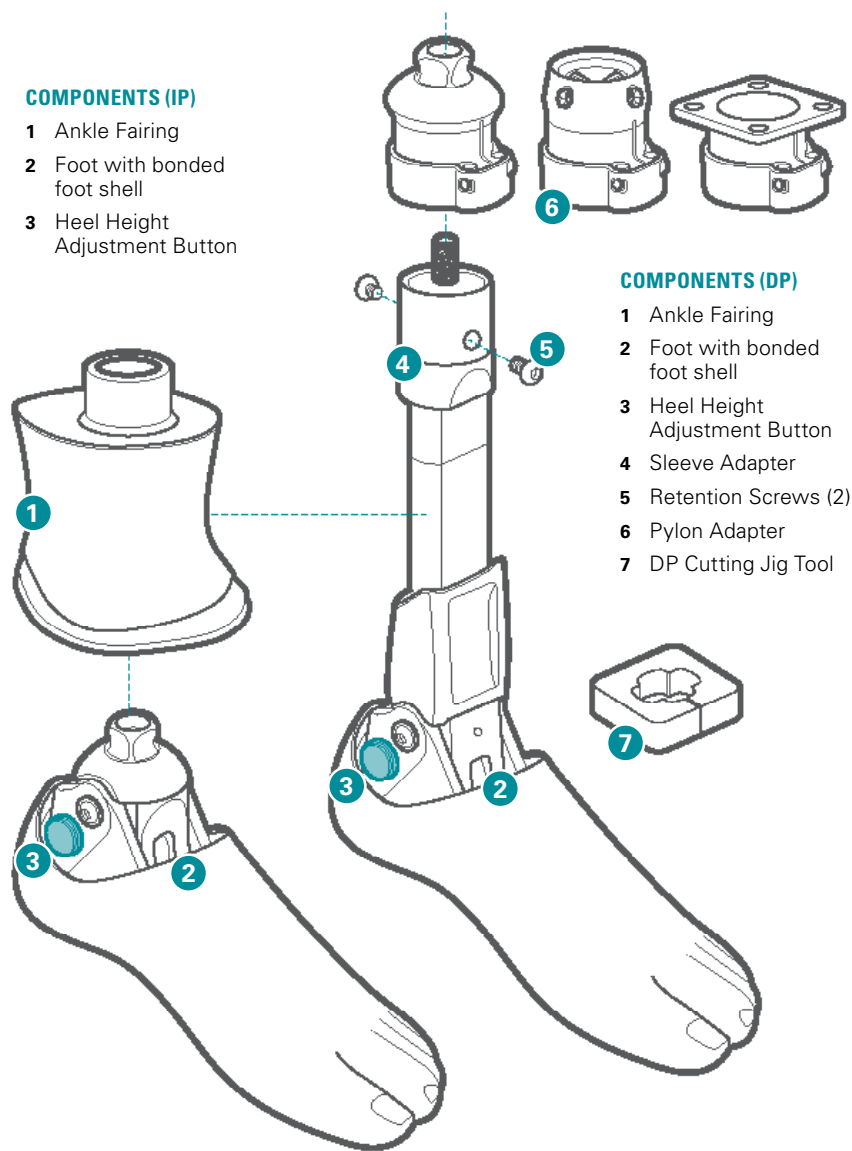

COMPONENTS (IP)

- 1 Ankle Fairing
- 2 Foot with bonded foot shell
- 3 Heel Height Adjustment Button

COMPONENTS (DP)

- 1 Ankle Fairing
- 2 Foot with bonded foot shell
- 3 Heel Height Adjustment Button
- 4 Sleeve Adapter
- 5 Retention Screws (2)
- 6 Pylon Adapter
- 7 DP Cutting Jig Tool

GENERAL INSTRUCTIONS

Mounting

Use only high quality proximal endoskeletal components (30 mm). The service-free Accent foot comes permanently assembled in the foot shell. *For DP mounting, refer to the Cutting a Dynamic Pylon and DP Sleeve Adapters Tech Tip guides.*

Heel Height Adjustment Button

The Heel Height Adjustment Button can be located on the medial or lateral side of the ankle. *The Accent foot ships with a medial button placement unless specified by the customer.*

Heel Height Adjustment

- 1 To adjust heel height, push in and hold the Heel Height Adjustment Button.
- 2 After the desired heel height is achieved, release the Heel Height Adjustment Button to engage the lock. Stand and apply a slight pressure to the heel to confirm that the mechanism is firmly seated.

Static Alignment

For optimal function, the load line should be positioned to divide the foot at 1/3 heel and 2/3 toe. In order to benefit from the full 2" (51 mm) of heel height adjustment, begin with the foot set in its most dorsiflexed position during initial alignment. This should be done in the lowest desired heel height position (shoe or barefoot), which will allow the widest range of adjustment for increased heel height requirements. Checking of the ideal alignment and function in multiple shoes and heels heights is also recommended.

Dynamic Adjustments

DESIRED RESULT	ALIGNMENT CHANGE
Firmer Toe Response	Plantarflex the Accent or move load line posterior
Softer Toe Response	Dorsiflex the Accent or move load line anterior
Firmer Heel Response	Dorsiflex the Accent or move load line anterior
Softer Heel Response	Plantarflex the Accent or move load line posterior

Cosmetics

The ankle fairing is required for both Dynamic Pylon (DP) and Integrated Pyramid (IP) options, to provide a smooth transition for cosmetic finishing and internal protection from environmental elements. To finish the assembly, refer to the *Accent Ankle Fairing / Cosmetic Finishing Instructions* (included with the ankle fairing).

Gait Matching® Guidelines

Contact College Park Technical Service if you have questions about modifying the gait match.

WARNING

- Do not expose this product to pH extremes or corrosive materials (water, salt water or other liquids).
- Failure to follow these technical instructions or use of this product outside the scope of its Limited Warranty may result in injury to the patient or damage to the product.
- Disassembly, modification or removal from the foot shell, or any further disassembly or modification of components will void the warranty.